

XSR SERIES

• 85 •

HYBRID



SARPYACHTS



True quality.

Easy words to say, but few stand in their own truth when they speak them, because true quality is demanding. It calls for the purest principles, the deepest commitments and only the truly dedicated will ever measure up.

But it's worth the search if you can find the road. There are subtle landmarks along the way and a discovery that drives you forward, and when you find true quality, it'll stop you in your tracks.

A supremely crafted superyacht is an unforgettable discovery, and it also tells a story. A story of absolute precision, trusted engineering, the finest materials and beautiful spaces, designed to be shared. Ultimately it's a story of those who built the yacht and their deep seated passion and determination to craft perfection.

When this comes to life in an exceptional superyacht, you can be sure you've uncovered true quality. Yours, to enjoy and a story to continue.

Sarp Yachts, the quality life deserves.



At Sarp Yachts we take the long road to quality investing the time, refining the detail, gathering the best around us and expecting the best of ourselves.

We believe when you craft things of beauty to create experiences to last, there's no other way to achieve it.

Our expert, in-house team ensured we achieved three certificates of Quality Evaluations from the American Bureau of Shipping We make sure the company we keep is both talented and respected, working with industry experts.

Our philosophy and attitude underpin the way we work with deep-seated passion and determination to craft perfection.

EMRE SANDAN, Shipyard Manager



Our Family Foundation Keeps It Personal.

Sarp Yachts is proudly owned by the Kanatlı family. The family also owns the ETI Group Companies making Eti and Sarp Group Companies two of the most influential and innovative entities in Turkey. Together, they lead the way in a spectrum of business categories including aeronautics, logistics, insurance, food and marine industry, with more than 10,000 employees. They are significant organisations, but collaboration with partners and clients is the key to the way we work – we will always keep it personal.



State Of The Art Shipyard



Sarp Yachts has founded one of the largest (10,000 m²) and most modern facilities in the Free Zone of Antalya in South Turkey. It's specifically designed for the new construction and refit of luxury motor and sailing yachts up to 80m in length.



perfect harmony of simplicity and style



SARP YACHTS

XSR SERIES

105 • 85 • 125

Silence is the keynote where pleasure enters.

In light of our environmentally friendly vision and high level engineering background, Sarp Yachts proudly present its brand new hybrid propulsion concept yacht family.

*We have great passion for nature and we are concerned about water and air pollution. Yachts with conventional propulsion systems may not be the first guilty party for the increasing pollution, but as a pioneering shipyard in the Antalya Free Zone, Sarp Yachts is aware of its responsibilities towards the environment. Therefore, our brand new concept yacht family, **XSR 85**, will be built with the parallel hybrid propulsion systems; the best alternative for the fossil fuels.*

The hybrid propulsion system enables you to avoid the noise, vibrations, emissions and expense of running your diesel generators at anchor.



Hull Design

Van Oossanen developed the patented 'Fast Displacement Hull Form' or FDHF. The development of this concept was triggered by the desire to develop a hull form that is efficient over the entire speed range and not only in a restricted speed interval around the maximum speed. Other benefits include significantly increased comfort on-board with better sea keeping and wave reduction. Particularly when compared to hard chine vessels, the FDHF showed improved sea keeping behaviour and manoeuvrability, as well as a reduced sensitivity to an increase in the weight of the vessel.



Low Emissions The XSR Series offers you the most environmentally friendly way to spend time aboard your boat. *Comfort & Silence* The system will allow for more space in the accommodation areas than a yacht at the same length. Electric engines operate silently with no exhaust gas. *Cost Efficiency* You can make slow cruises by utilising electric propulsion with nearly zero cost! The maintenance period of electric engines is also longer than internal combustion engines. *Engine Power* We provide you a maximum acceleration value regardless of propulsion revolution or the yacht's speed; an efficient and powerful cruise with the highest manoeuvrability.



XJR 85



XJR 85

COLORS







XJR 85 can accommodate 8 guests and 4 crews. Full-beam Owner Cabin on aft lowerdeck with his & her walk-in-closet and bathroom, Port Guest Cabin with twin bed and bathroom, Stbd Guest Cabin with double bed and bathroom, full-beam VIP Cabin on forward with walk-in-closet and bathroom, which is convertable to TV Lounge.



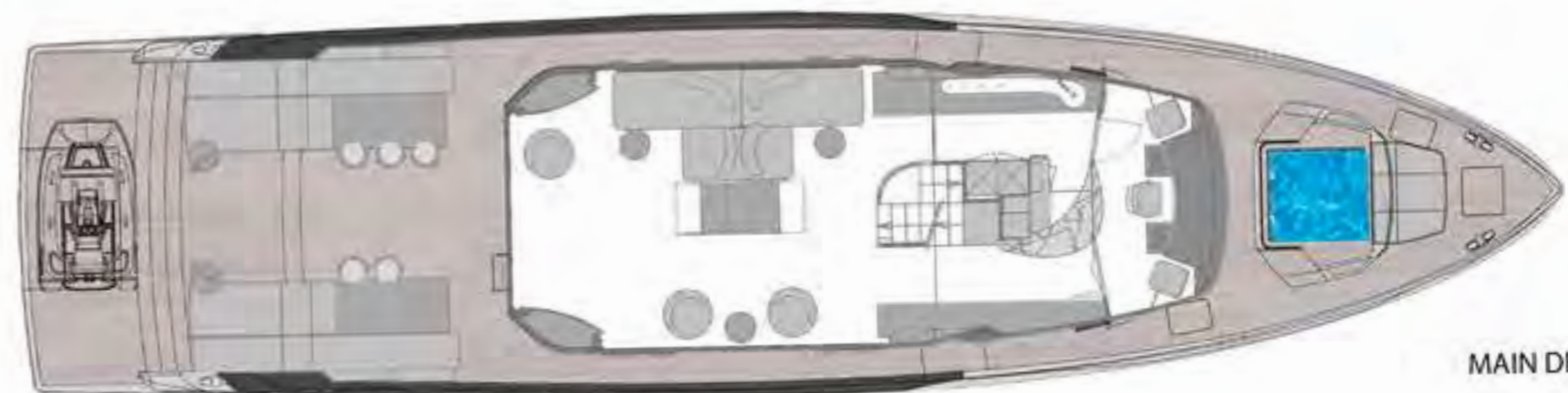

MAIN DECK



UPPER DECK

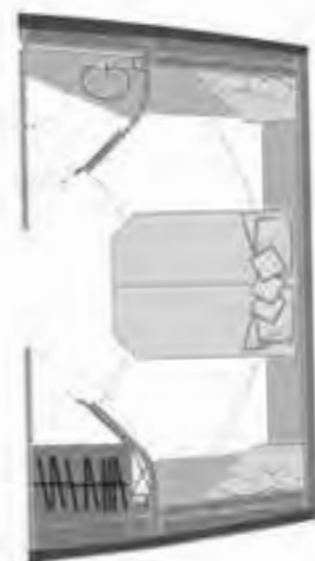

LOWER DECK



Interior

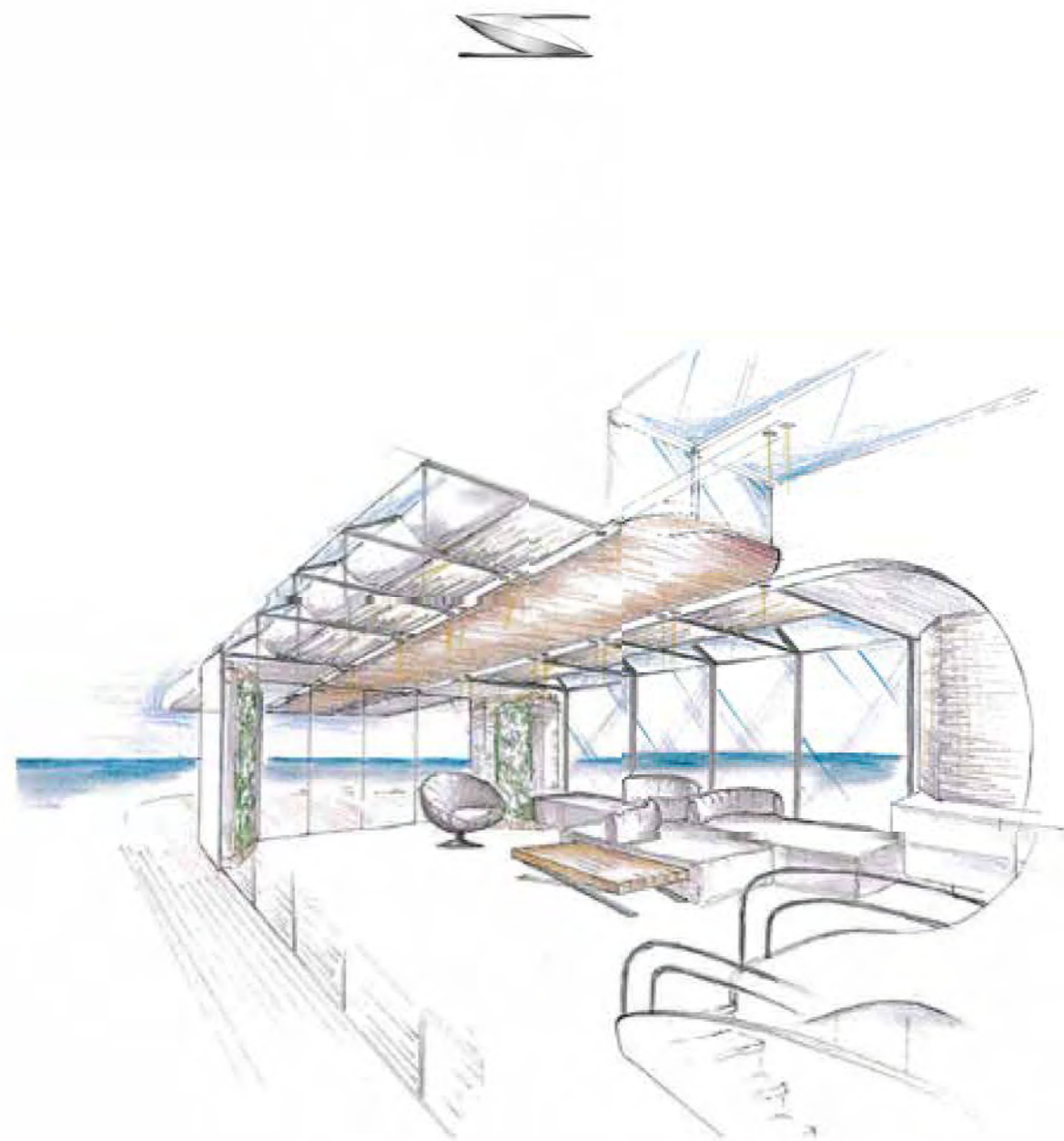

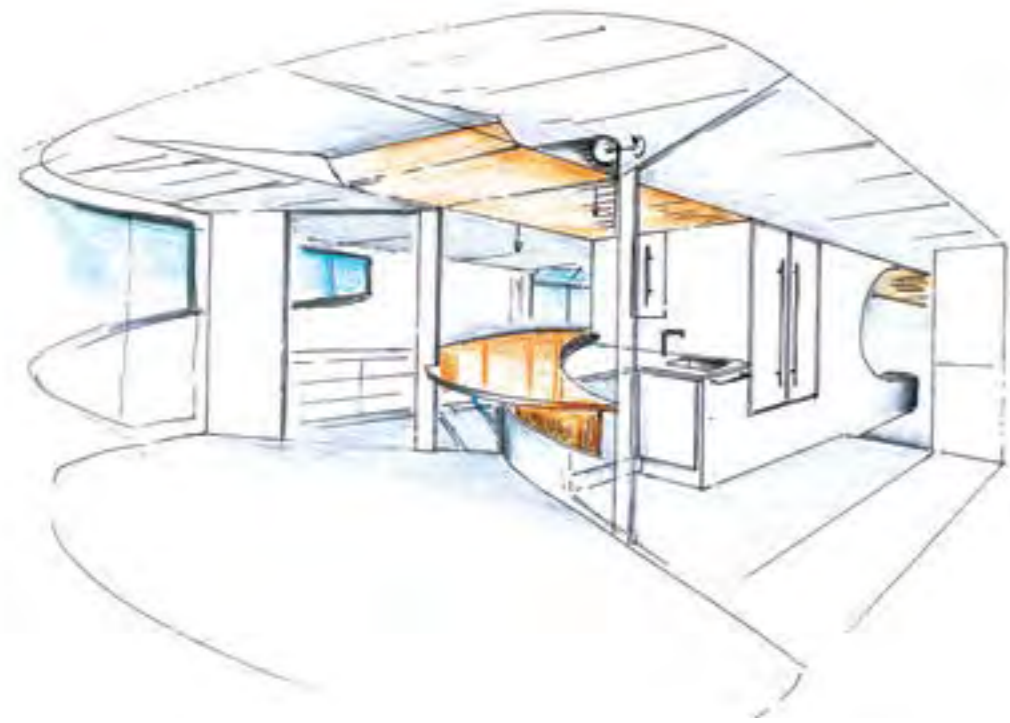

The beauty of Nature, touchable surfaces, sustainable materials, clean technology , designed to embrace, pampering the eye.



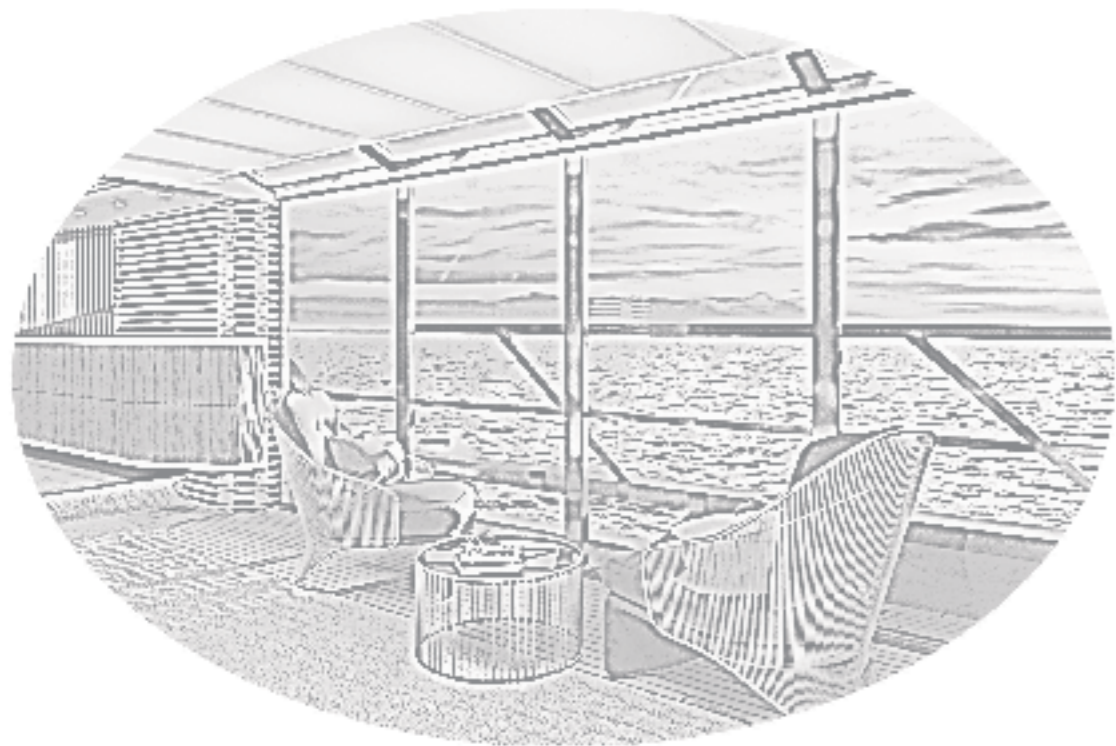

Elegance in simplicity, a safe bowery oasis , floating the sea.
Reflecting the freedom of exploring the horizon.





Watching a movie, playing a game, taking a nap, check your mails.... without losing the connection with the rest of the party, you can find your Cozy corner. In the evening the sofas transform into a spacious bed, hidden doors restore privacy and the Video beamer finds a new projection location. A walk-in closet and soft shaped bathroom complete the comfort.



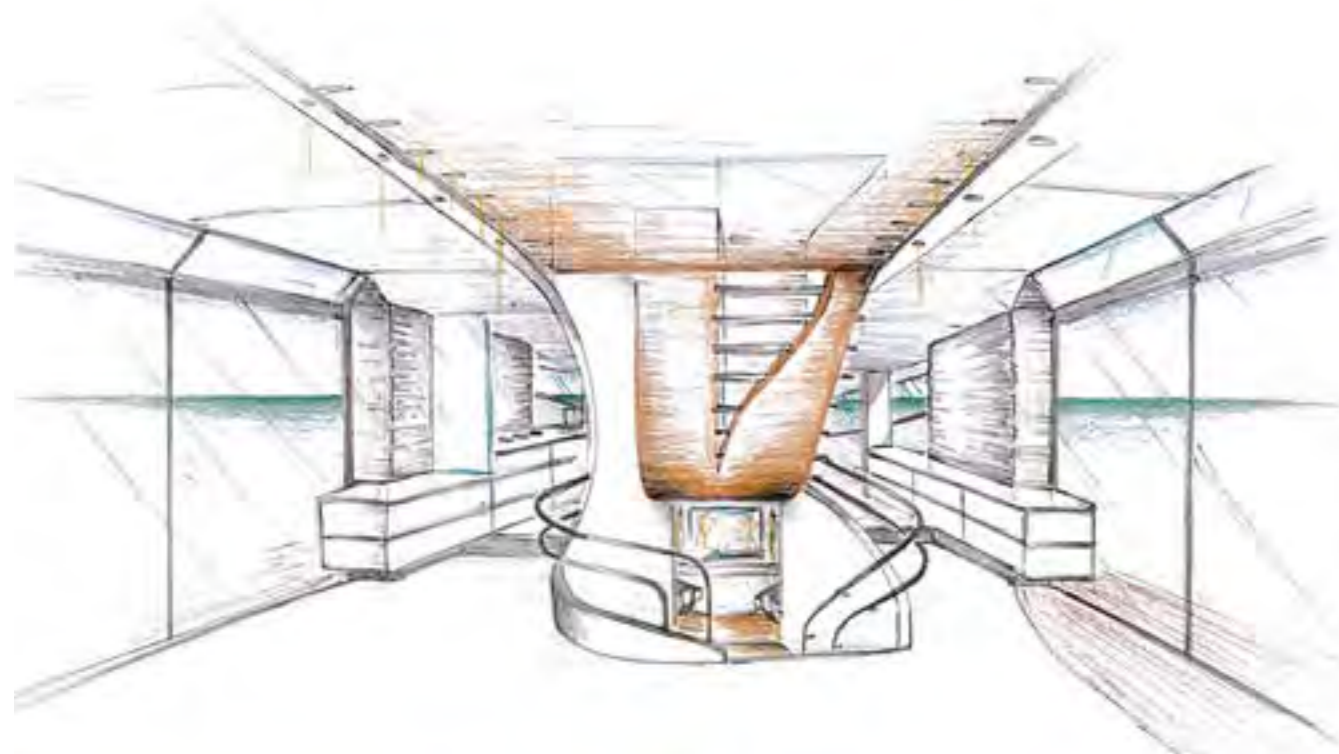

The sculptural staircase connects in one sweeping line all levels to a logical composition. Fluid lines scooping the daylight from the Sundeck into the hart of the ship.



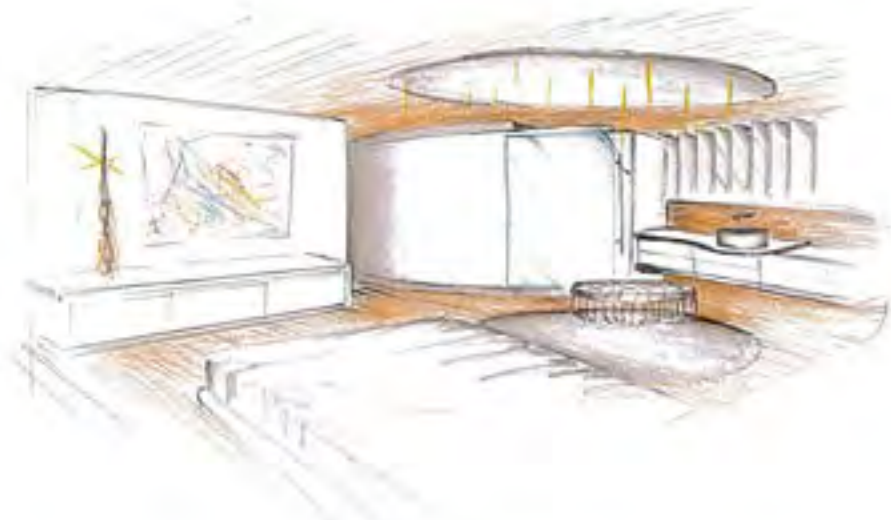

Aft of the lower deck is dedicated to the master cabin. All functional elements are arranged around a surprisingly fluid space. The absence of bulky furniture and space intruding t.v screens , allows the carefully chosen material structures to shine and define





Specifications



SPECIFICATIONS

XSR 85 Hybrid

Hull Type:	Fast Displacement Hull Type Twin Screw Diesel Motor Yacht
Naval Architect:	Van Oossanen Naval Architecture
Exterior Design:	Red Yacht Design
Interior Design:	Art-line Interiors
Classification:	CE
Hull:	Composite
Superstructure:	Composite

DIMENSIONS

Length over all:	26.00 meters
Beam over all:	6.46 meters
Design Draft (full load):	1.19 meters
Max. Draft (full load):	1.26 meters
Displacement (full load):	80 tons (approx.)
Gross Tonnage:	125

ACCOMMODATION

Crew:	4
Guests:	8
Cabins:	Full-beam Owner Cabin with his & her walk-in-closet and bathroom, Port Guest Cabin with twin bed and bathroom, Stbd Guest Cabin with double bed and bathroom, full-beam VIP Cabin with walk-in-closet and bathroom, convertable to TV Lounge.

TECHNICAL DETAILS

Maximum speed:	22 knots with e-boost
Range at 12 knots:	1000 Nm (cruising speed)
Fuel capacity:	7.850 liters
Fresh water:	2.250 liters

PROPULSION DETAILS

Main diesel engines:	2 x MAN i6 - 800 bhp @2300 rpm
Gearbox:	2 x ZF 550 - 1 V, 2.95:1 ratio
Electric engines:	2 x Praxis 50 kW @1500 - 3000 rpm
Main generators:	2 x Kohler 70kW,
Bowthruster:	1 x Side Power 37kW
Stabilizers:	2 x CMC Stabilis Electra SE60
Interceptor:	2 x Humphree HE950



“We believe our clients are not just buying a yacht. They are also buying time. Uninterrupted time away from the demands of life. We ensure our yachts are built to the highest standard to ensure time spent onboard delivers the ultimate enjoyment and creates stories to share.”



SARPYACHTS
www.sarpyachts.com info@sarpyachts.com

The Quality Life Deserves