

PROFILE

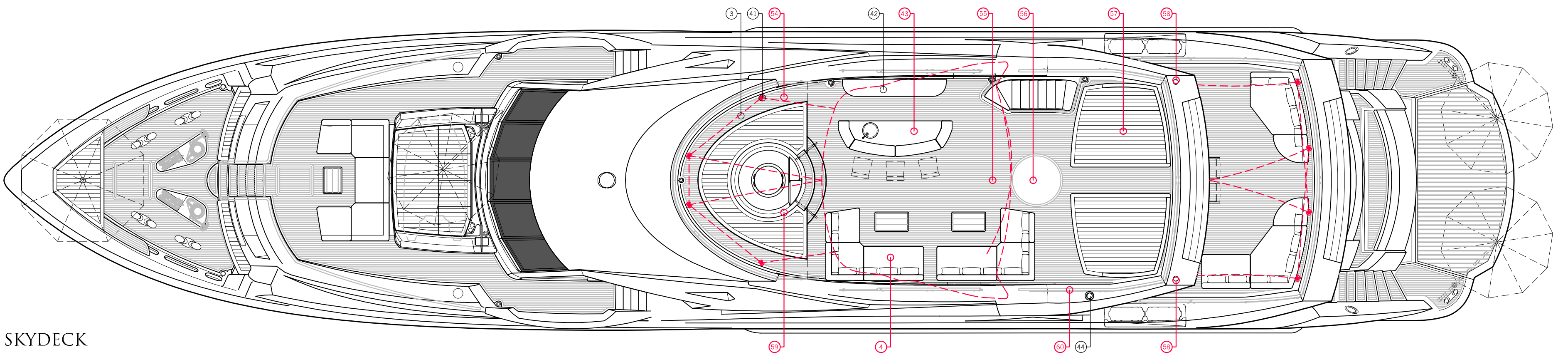

SKYDECK

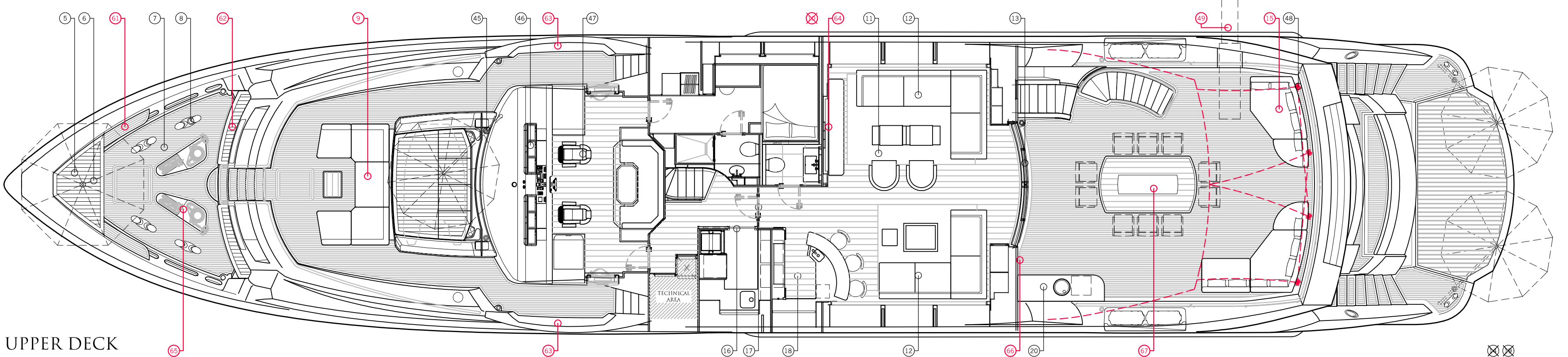

UPPER DECK

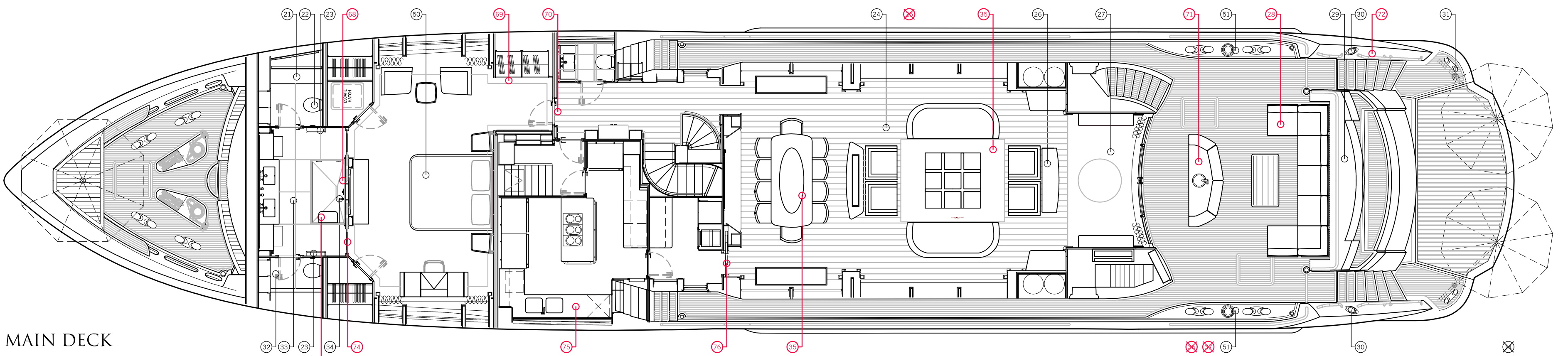

MAIN DECK

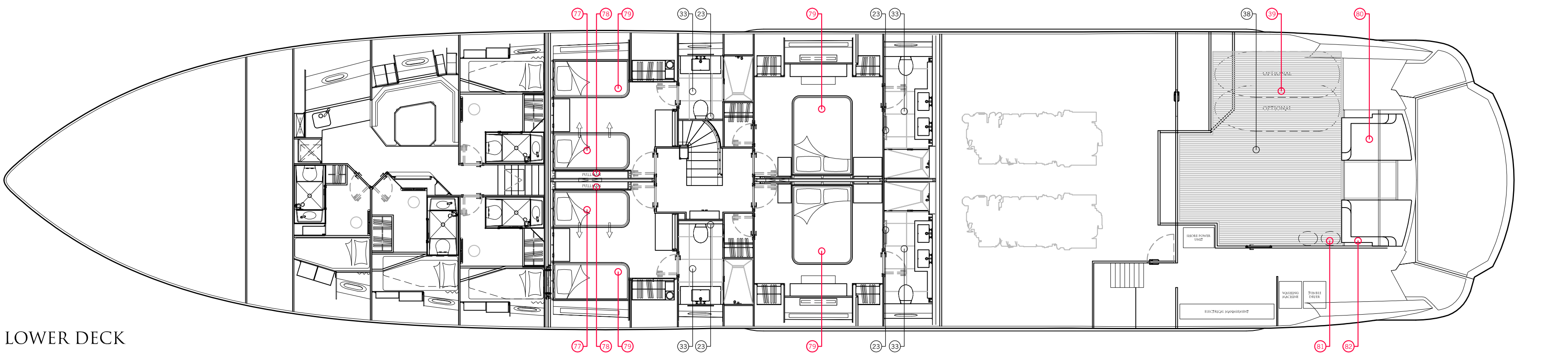

LOWER DECK

NO.	DATE	CHANGES FROM STANDARD	NO.	DATE	CHANGES FROM STANDARD	NO.	DATE	CHANGES FROM STANDARD
1	27.10.17	Option - Upgraded navigation mast with second radar	24	20.12.17	Option - Wooden flooring to main deck lobby, dining & saloon areas with inset inset carpet in saloon area	48	20.12.17	Special - Sail canopies for upper deck aft cockpit as per 61319131 (configuration tbc)
2	27.10.17	Special - Removable safety rails for fwd side of platform	25	15.01.18	Option - Stbd side patio door - Cancelled	49	12.01.18	Special - Diving board. Custom railing to suit (under investigation)
3	27.10.17	Special - Infill cushions required for fwd sunpad	26	20.12.17	Option - Stbd side patio door - Cancelled	50	20.12.17	Special - Custom master stateroom furniture
4	12.01.18	Option - Standard seating arrangement with central side table removed	27	27.10.17	Special - Stone entrance flooring tbc	51	20.12.17	Special - Stainless steel deck plates on aft mooring plinth
5	27.10.17	Option - Forepeak sunpad	28	12.01.18	Special - Fischer Möbel Suite seating arrangement with teak coffee table	52	12.01.18	Special - Infill panel in lieu of standard handrail
6	27.10.17	Special - Parasol for forepeak seating area	29	27.10.17	Special - Custom stern moulding (rails modified to suit)	53	12.01.18	Special - VSAT dome in lieu of second radar (under investigation)
7	27.10.17	Option - Forepeak teak decking	30	27.10.17	Option - Aft towing fairleads	54	12.01.18	Option - Infill cushions for fwd sunpad surround
8	27.10.17	Option - Additional pair of mooring bollards	31	27.10.17	Special - 2 x Parasols on bathing platform as per 604	55	12.01.18	Special - Fixing on underside of hardtop for swing chair (as per 60416131)
9	12.01.18	Special - Deep lounge foredeck seating arrangement with rise and fall coffee table	32	27.10.17	Special - Toilet room	56	12.01.18	Special - Inset glass feature (as per 60416131)
10	12.01.18	Special - Drop down screen (under investigation) - Cancelled	33	27.10.17	Special - Underfloor heating in every en suite and both master en suite toilet rooms	57	12.01.18	Special - Port and stbd sunpad (as per 60416131)
11	27.10.17	Option - Wooden flooring to upper deck wheel house & saloon with inset carpet in seating areas	34	27.10.17	Option - Central shower arrangement	58	12.01.18	Special - Port and stbd speaker pole socket (as per 61319131)
12	20.12.17	Special - Custom seating arrangement	35	12.01.18	Special - Custom dining and saloon arrangement	59	12.01.18	Special - Teak capping for spa tub (as per 60416131)
13	27.10.17	Special - Custom 4 panel centre opening patio door	36	12.01.18	Special - Inset glass feature (as per 60416131) - Cancelled	60	12.01.18	Special - Removable port side rail (as per 60416131)
14	20.12.17	Special - Removable diving board. Custom railing to suit (under investigation) - Cancelled	37	12.01.18	Special - Aft cockpit wet berth - per 613 - Cancelled	61	12.01.18	Special - Port and stbd teak steps
15	12.01.18	Special - Seating corner infills required port and stbd, stbd seating return removed	38	27.10.17	Option - Garage synthetic teak flooring	62	12.01.18	Special - Seat pads for fwd step (as per 60416131)
16	27.10.17	Special - Sliding door	39	12.01.18	Option - 2 x customer supply Sea-Doo RXP-X 300	63	12.01.18	Special - Raymarine IS70 and VHF handsets to be fitted on port & stbd wing stations
17	27.10.17	Special - Door to separate Upper Deck saloon	40	20.12.17	Option - Hardtop aft canopy	64	12.01.18	Special - 19mm Gypsy and anchor chain in lieu of standard (as per 61218131)
18	20.12.17	Special - Open bar arrangement with custom bar unit	41	20.12.17	Special - Sail canopies for fwd end of skydeck as per 61319131 (configuration tbc)	65	12.01.18	Special - Raymarine Axiom 7" navigation display
19	20.12.17	Special - Raised bar top to be reduced 100mm in depth with an angle on the inboard edge - Cancelled	42	20.12.17	Special - Custom storage	66	12.01.18	Special - Custom dining table
20	27.10.17	Option - Side bar to contain cool box, ice machine & sink as per 608	43	12.01.18	Special - Custom wet bar	67	12.01.18	Special - Steam shower
21	27.10.17	Special - Basin removed	44	20.12.17	Special - Rescue crane socket as per 60416131	68	12.01.18	Special - Wooden flooring border
22	27.10.17	Option - Toilet only, bidet removed	45	20.12.17	Option - Parasol with socket port & stbd	69	12.01.18	Special - Swipe card access for Master Stateroom (under investigation)
23	27.10.17	Option - Heated towel rail in every en-suite	46	20.12.17	Option - Upgraded 6 screens arrangement	70	12.01.18	Special - Wetbar (as per 71016116)
			47	20.12.17	Option - 2 x helm seats (positioned on port & stbd sides)	71	12.01.18	Special - Wetbar (as per 71016116)
						72	12.01.18	Special - Stbd services locker to house 32A Marino outlet to provide power to chase boat

<p>DESIGN OFFICE SUNSEEKER INTERNATIONAL LIMITED TECHNICALS DEPT MANNSFIELD ROAD POWELL CROFT ENGLAND N.T.S @ AI</p>	<p>PROJECT REFERENCE: S210</p> <p>PROJECT NAME: 131 YACHT</p> <p>PROJECT NUMBER: 61519131</p>	<p>DATE: 12.01.18</p> <p>PROJECT STATUS: See spec notes, 4, 9, 10, 15, 25, 26, 35, 36, 37, 39, 43, 49, & 52 to 82</p>
<p>CUSTOMER GENERAL ARRANGEMENT</p> <p>S210-39-995-001</p> <p>1 OF 1</p>		